

TIPPER SAFETY STAND INSTRUCTIONS

PART NO: TQA-SAFE-01

Manufactured in accordance with AS1418.8 Sections 2.6.3b, 4.4.4b, 4.4.4d

WARNING:

- Always inspect Tipper Stands for cracks or damage /excessive wear prior to use. Do NOT use if any damage is suspected.
- Always inspect Tipper bin pivot points for excessive wear, cracks or damage prior to use. Do NOT use if any damage is suspected.
- Ensure vehicle park brakes are applied and wheels are chocked.
- Tipper bin **MUST BE EMPTY** while Tipper Stands are in use.
- Ensure that the Tipper Stands Clevis and Lynch Pins are secure prior to use.
- Tipper Stands must be used as a pair.
- Each Tipper Stand has a STATIC VERTICAL load rating of 5,000kg (10,000kg per pair).
- Stand clear whilst releasing hydraulic pressure from the cylinder, as the Tipper Stands are loaded.
- Ensure there is no movement of bin before commencing work underneath.
- Tipper Stands are not meant to be used for long periods of time. Eg. Overnight.

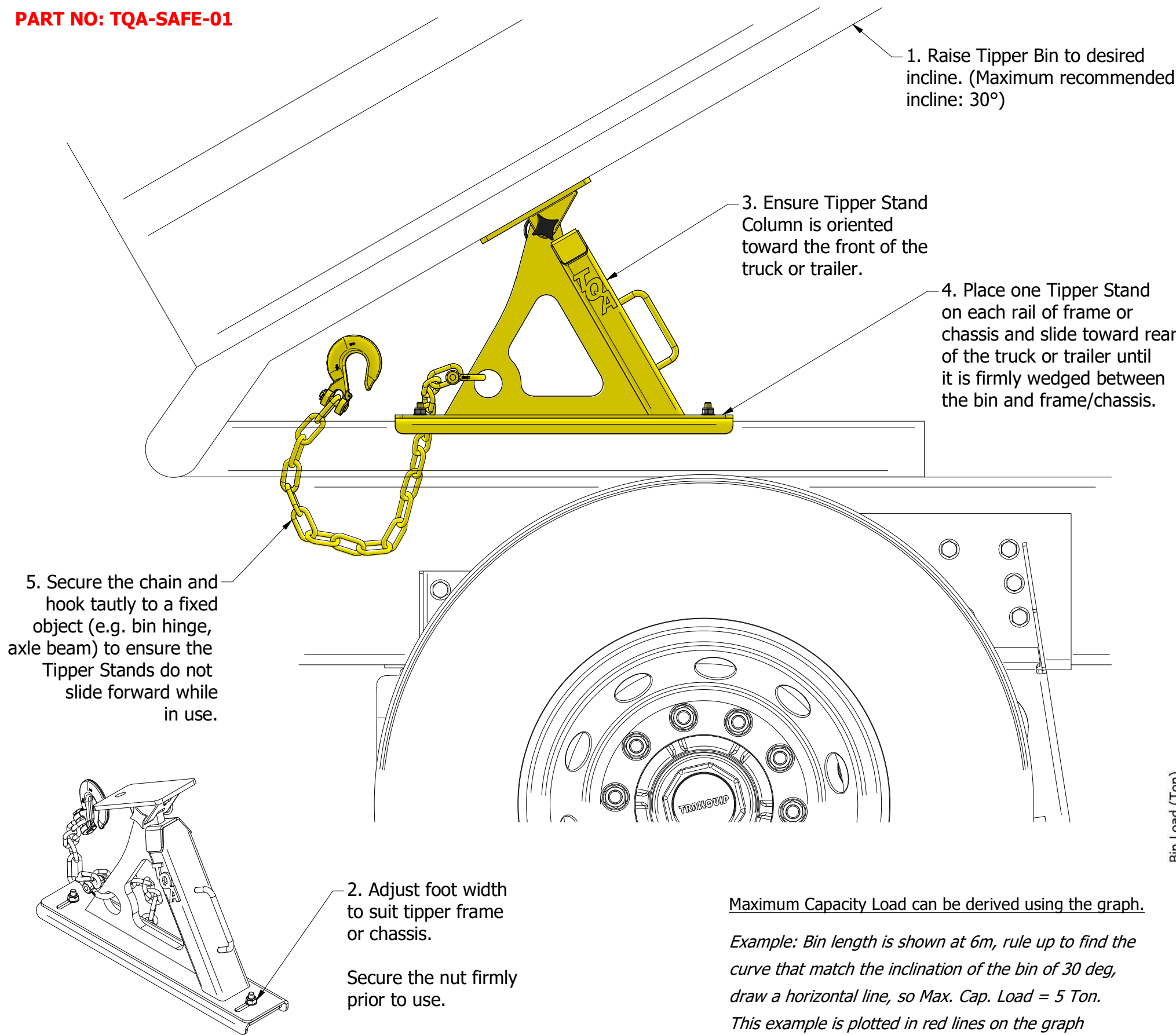

MAXIMUM CAPACITY LOAD (Using graph)

Tipper Safety Prop Ratings (Pair)

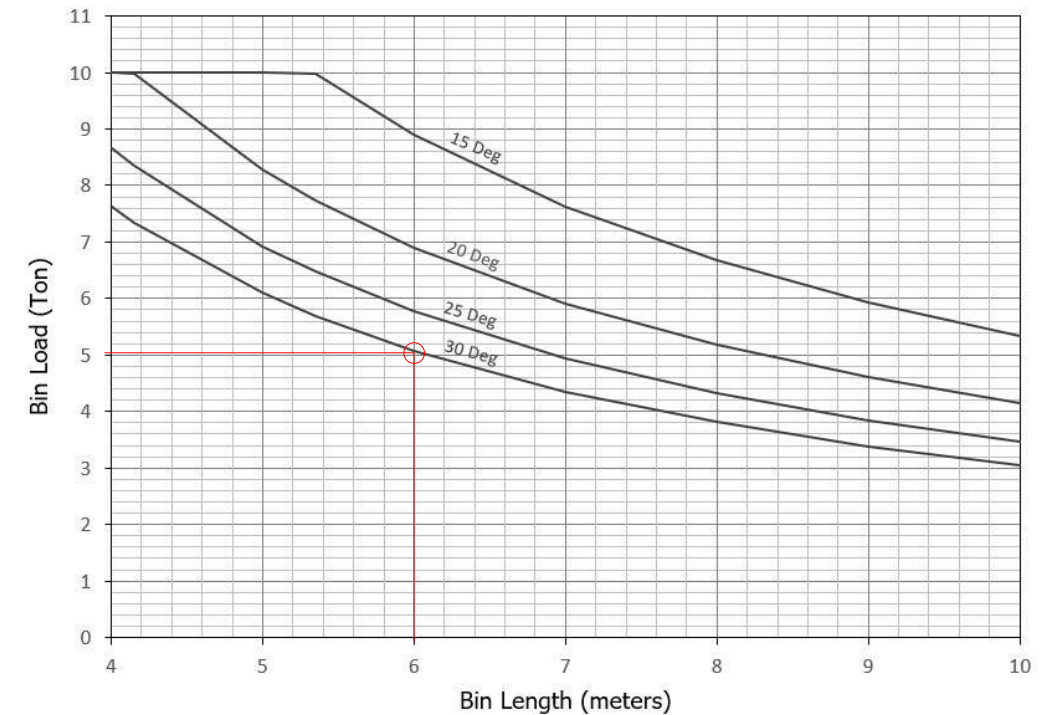

Maximum Capacity Load can be derived using the graph.

Example: Bin length is shown at 6m, rule up to find the curve that match the inclination of the bin of 30 deg, draw a horizontal line, so Max. Cap. Load = 5 Ton.
This example is plotted in red lines on the graph

**AIR BRAKE SERVICES
TRAILQUIP**

1898 Ipswich Rd, Rocklea
QLD, 4106, Australia
www.abstrailquip.com

T.: (07) 3274 6046
F.: (07) 3274 6048

ABN: 89 126 053 521

Air Brakes Axles Suspensions Rims Lights Landing Legs

REV	DESCRIPTION OF CHANGE	DATE	INITIALS	APPROVED
B	CAPACITY GRAPH ADDED	09/22	ASF	KT
A	NOTES ADDED	06/21	WW	KT

Copyright © ABS Trailquip Pty Ltd

ALL RIGHTS RESERVED. THE INFORMATION IN THIS DOCUMENT IS SUBJECT TO TERMS AND CONDITIONS OF THE AGREEMENT OR CONTRACT UNDER WHICH THE DOCUMENT WAS SUPPLIED TO THE RECIPIENT'S ORGANISATION. NO INFORMATION IN THIS DOCUMENT OR PART OF THIS DOCUMENT SHALL BE:
(A) DISCLOSED OUTSIDE RECIPIENT'S OWN ORGANISATION
(B) REPRODUCED OR TRANSMITTED IN ANY WAY OR STORED IN ANY RETRIEVAL SYSTEM WITHOUT PRIOR WRITTEN CONSENT OF ABS TRAILQUIP PTY LTD.

MANUFACTURING TOLERANCES	
FABRICATION	
0 - 500:	+0,-1
501 - 2000:	+0,-2
2001 - 5000:	+0,-2
> 5000:	+0,-5
DRILL HOLE	
6 - 12 MM:	+0.2,-0
13 - 20 MM:	+0.3,-0
20 - 26 MM:	+0.3,-0
26 - 39 MM:	+0.4,-0
MACHINING	
0 =	+/- 0.5MM
0.0 =	+/- 0.1MM
0.00 =	+/- 0.05MM

DRAWN ASF	1/06/2021
CHECKED	
MFG	
APPROVED	
SHEET 1 OF 1	SCALE 1 / 7

SIZE A3	PROJECT / JOB SAFETY
TITLE Tipper Safety Stand Instructions	
PART NUMBER	TQA-SAFE-01B